6-11. STEERING KNUCKLE AND ARM MAINTENANCE (ALL EXCEPT M1009).

This task covers: a. Disassembly b. Assembly

INITIAL SETUP:

Equipment Condition

- Steering tie-rod removed.
(See TM 9-2320-289-20)
- Connecting rod disconnected from steering arm (left side). (See TM 9-2320-289-20)
- Front axle shaft removed,
(See paragraph 6-4)

Materials/Parts

- One gasket
- Two seals
- Eight lockwashers
- Grease (Item 36, Appendix B)

Tools/Test Equipment

- Socket wrench adapter, J-26871-A
- Torque wrench

General Safety Instructions

- Nuts at steering arm, or bolts at upper kingpin bearing cap, must be removed alternately and with caution.
-

a. DISASSEMBLY

WARNING

Nuts at steering arm or bolts at upper kingpin bearing cap must be removed alternately and with caution. Compression spring underneath steering arm or bearing cap could fly up during removal, causing serious injury to personnel.

6-11. STEERING KNUCKLE AND ARM MAINTENANCE (ALL EXCEPT M1009)
(Con't).

NOTE

- On left side, steering arm (3) is installed to steering knuckle (8) with 4 nuts (2). On right side, upper kingpin bearing cap is installed to steering knuckle with 4 bolts and lockwashers.
 - Left side disassembly is given.
1. Remove 4 nuts (2) alternately at steering arm (3). Remove steering arm, spring (4), and spring retainer (5). Remove gasket and discard. If present, discard 4 lockwashers.

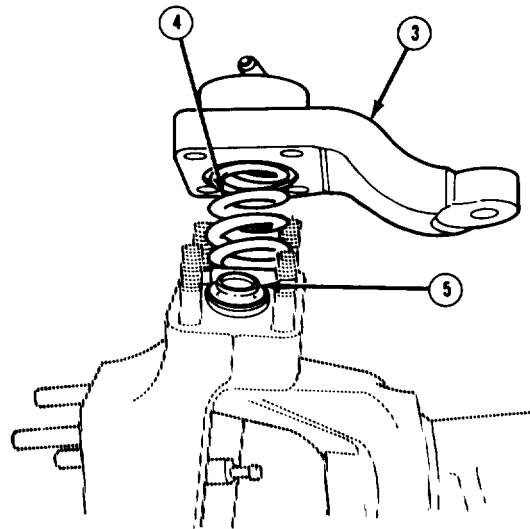
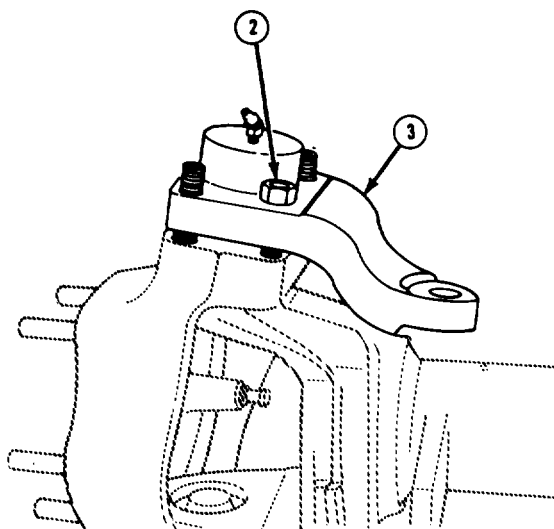

2. Remove 4 bolts (16), lockwashers, and lower kingpin bearing cap (15) from steering knuckle (8). Discard lockwashers,

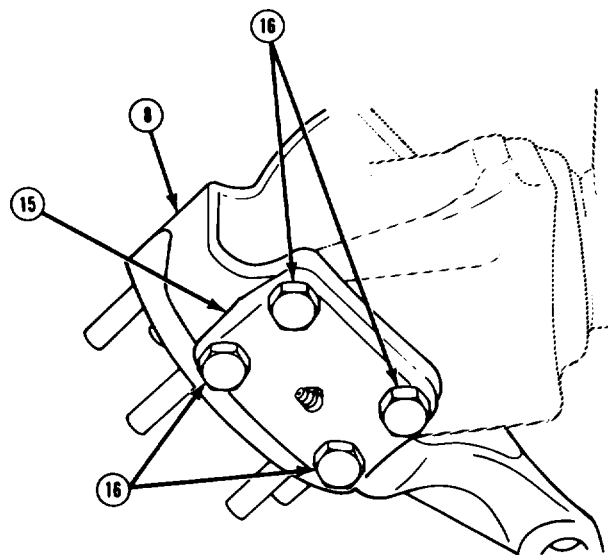

TA50563

6-11. STEERING KNUCKLE AND ARM MAINTENANCE (ALL EXCEPT M1009)
(Con't).

3. Remove kingpin bushing (7) from top of steering knuckle (8). Remove steering knuckle from axle housing (9).

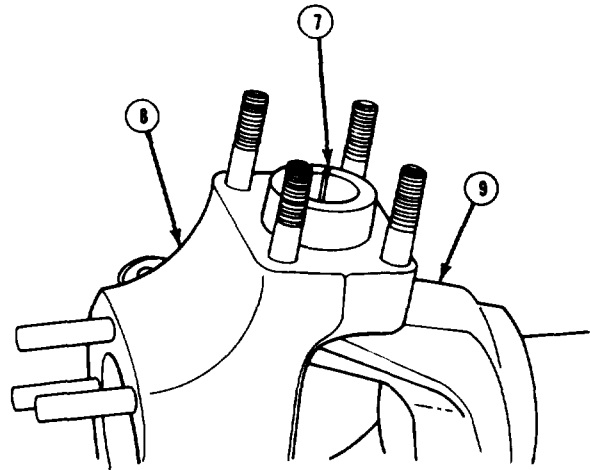

NOTE

Upper kingpin (6) is tightened to 550 lb.-ft. (746 N.m).

4. Remove seal (10) from upper kingpin (6). Remove upper kingpin from axle housing (9). Discard seal.
5. inspect upper kingpin (6) and kingpin bushing (7) for damage. Replace if damaged.

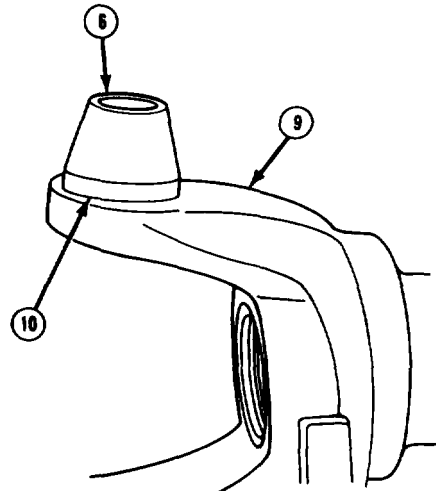

TA50564

6-11. STEERING KNUCKLE AND ARM MAINTENANCE (ALL EXCEPT M1009)
(Con't).

6. Remove seal (14) and bearing (13). Inspect bearing for damage and binding, Replace if damaged or binding. Discard seal. If damaged, remove bearing cup (12) and retainer (11).
7. Inspect all grease fittings and replace if damaged.

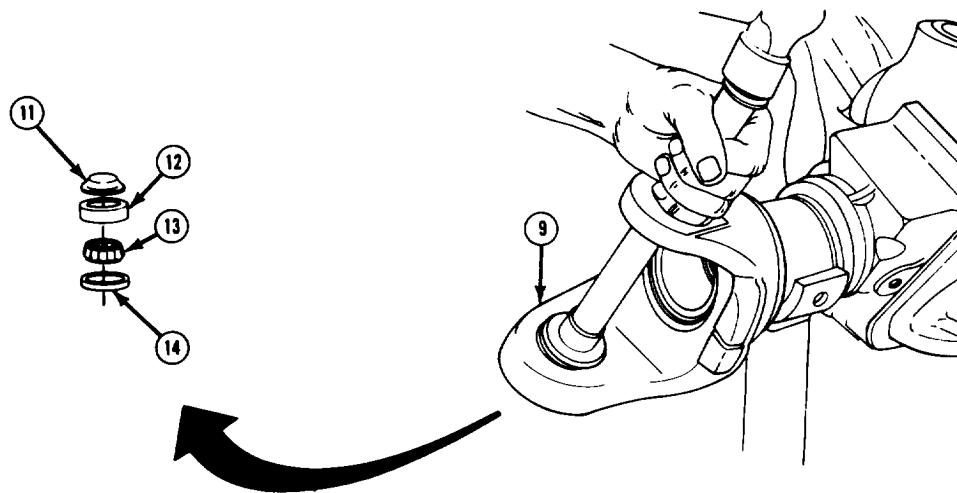

b. ASSEMBLY

NOTE

- On left side, steering arm is installed to steering knuckle (8) with 4 nuts. On right side, upper kingpin bearing cap is installed to steering knuckle with 4 bolts and lockwashers.
 - Left side assembly is given,
 - Seal (14) will protrude slightly from surface of axle housing (9) flange when installed.
1. If removed, assemble retainer (11) and bearing cup (12), and install to axle housing (9) flange. Fill area in retainer with grease. Grease bearing (13) and install, Install new seal (14).

6-11. STEERING KNUCKLE AND ARM MAINTENANCE (ALL EXCEPT M1009)
(Con't).

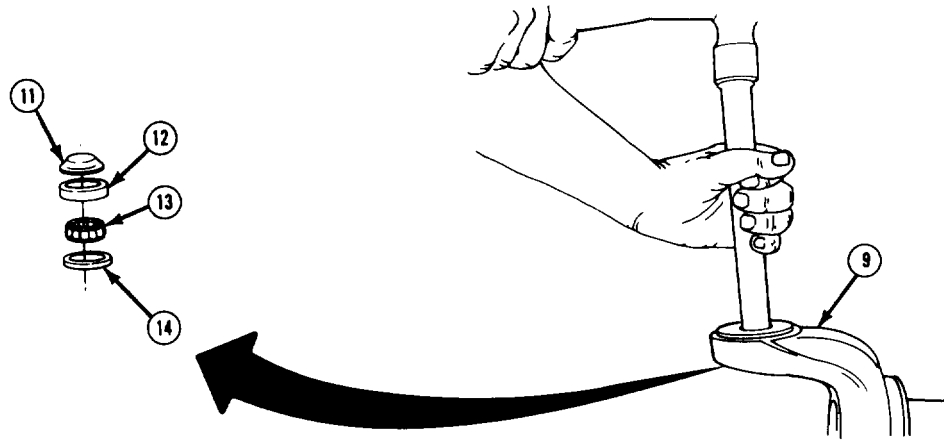

2. Install upper kingpin (6) to axle housing (9) and tighten to 550 lb.-ft. (746 N.m). Install new seal (10) to upper kingpin with lip facing up.
3. Grease upper kingpin (6) and install steering knuckle (8) to axle housing (9).

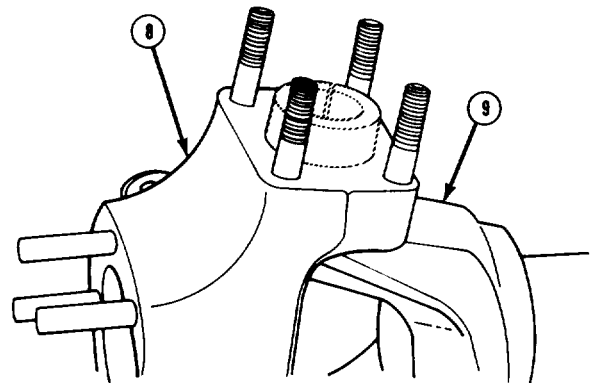
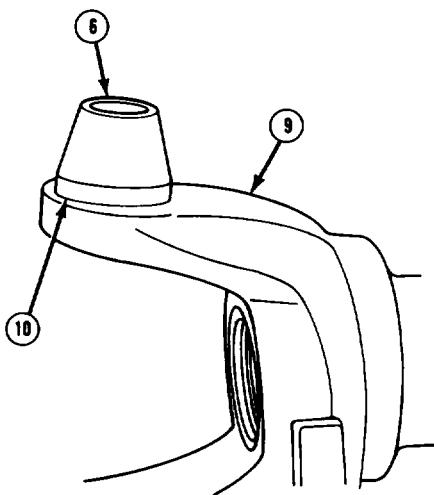

6-11. STEERING KNUCKLE AND ARM MAINTENANCE (ALL EXCEPT M1009)
(Con't).

4. Install lower kingpin bearing cap (15) with 4 new lockwashers and bolts (16). Tighten bolts to 80 lb.-ft. (108 Nom).

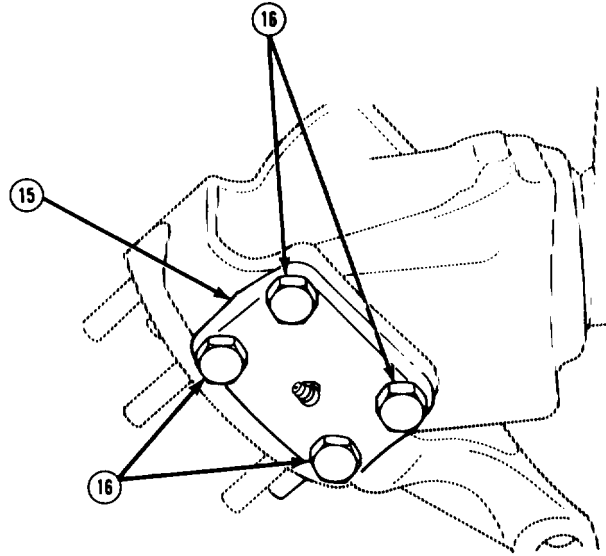

5. Install kingpin bushing (7) to top of steering knuckle (8) with ridge on bushing indexed with slot in axle housing (9).

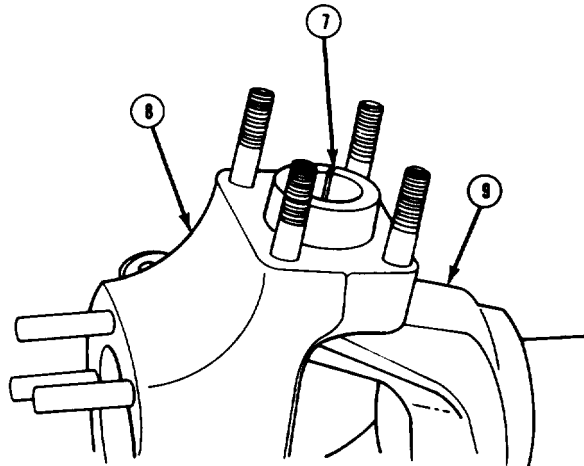

TA50567

 6-11. STEERING KNUCKLE AND ARM MAINTENANCE (ALL EXCEPT M1009)
 (Con't).

CAUTION

Nuts (2) at steering arm (3) or bolts at upper kingpin bearing cap should be installed alternately and in increments. Failure to follow this caution may result in damage to stud threads or to bolts.

NOTE

On right side, 4 new lockwashers are used with bolts.

6. Assemble spring retainer (5) with collar facing up and spring (4) on kingpin bushing (7) over upper kingpin (6). Install new gasket and steering arm (3) over steering knuckle studs (1). Install 4 nuts (2), and tighten alternately and in increments to 80 lb.-ft. (108 N.m).

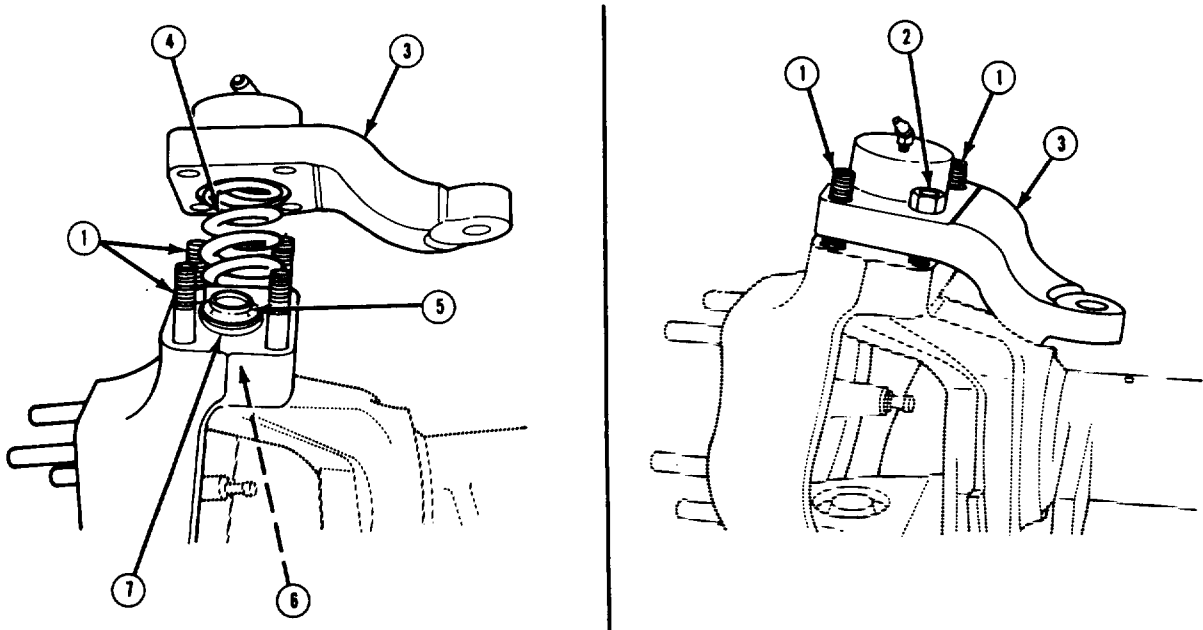

FOLLOW-ON TASKS:

- Lubricate steering knuckle and arm. (See LO 9-2320-289-12)
- Install front axle shaft. (See paragraph 6-4)
- Connect connecting rod to steering arm if removed. (See TM 9-2320-289-20)
- Install steering tie-rod. (See TM 9-2320-289-20)

TA50568